

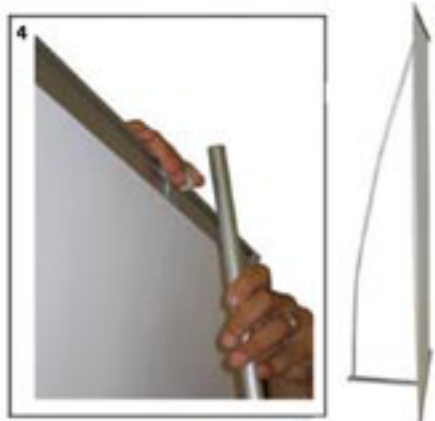

1. Snap the two aluminum rails open. Place them at top of edge of banner and snap them on.

2. Turn base perpendicular to bottom rail (turning the screw)

3. Insert aluminum shaft into base hole.



4. bend shaft formed by three tubes to the special connection jointed with the upper rail.

BANNER:

Sharp edged, 200x200cm
Other sizes available upon request.

STUDIO STANDS.it
soluzioni espositive

INSTRUCTIONS LEAFLET
SKATTO-MAXI

