

# STANDY

## SIGNS AND SIGNAGE

Standy is a single/double-sided totem composed of an exhibition auction height adjustable (160 cm - 220 cm). Assembly is quick and easy, ideal for points of sale.

## CHARACTERISTICS

The rod hooks hold the press in tension

Adjustable height thanks to the rod telescopic from 160 cm to 220 cm.

Round metal base.

Easy assembly, no tools.

## PLUS

double-sided graphics (above 190 cm a graphic height is recommended single-sided).

Versatile and adaptable to different exhibition needs.

quick and easy graphics changes.

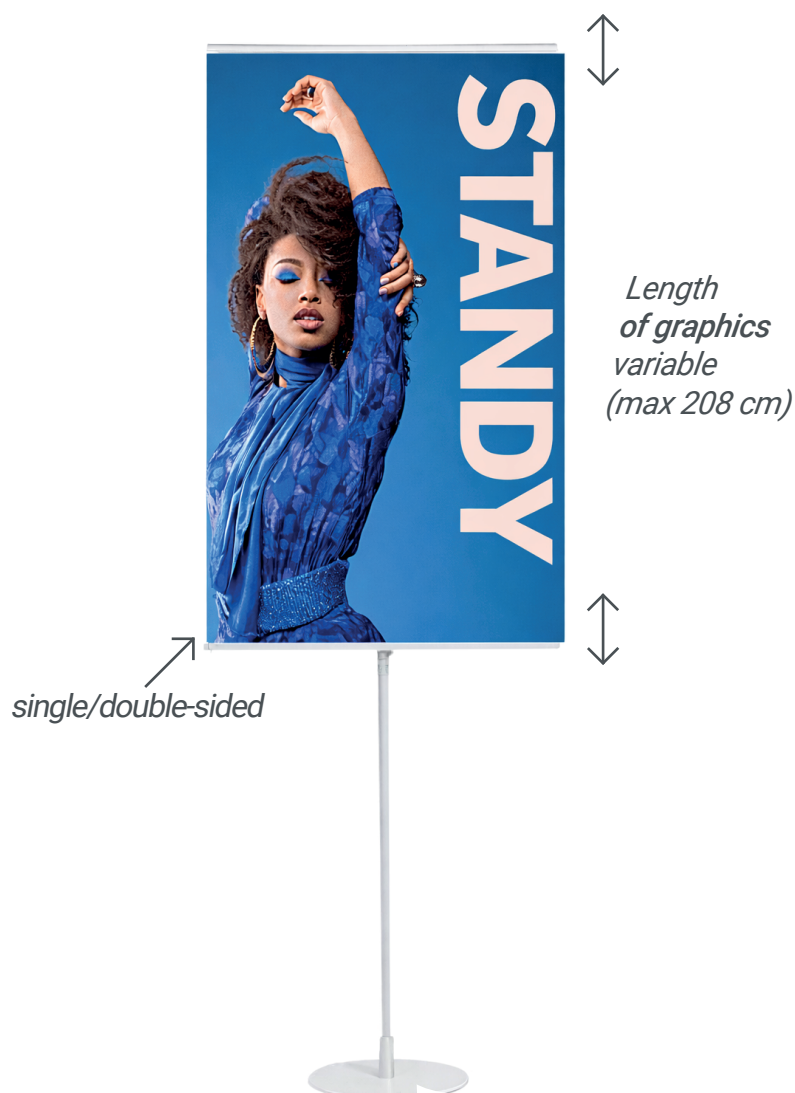

Attaching the rod to the profile



round base



carrying bag (base excluded)



double-sided

code	description	Structure dimensions (mm) - l x h x p	Structure weight assembled	size of the neck (mm) - l x h x p	weight neck
	standy	600 x 1600	12,5 kg	330 x 330 x 980	13 kg

# STANDY

## SIGNS AND SIGNAGE

Structure dimensions



graphic area

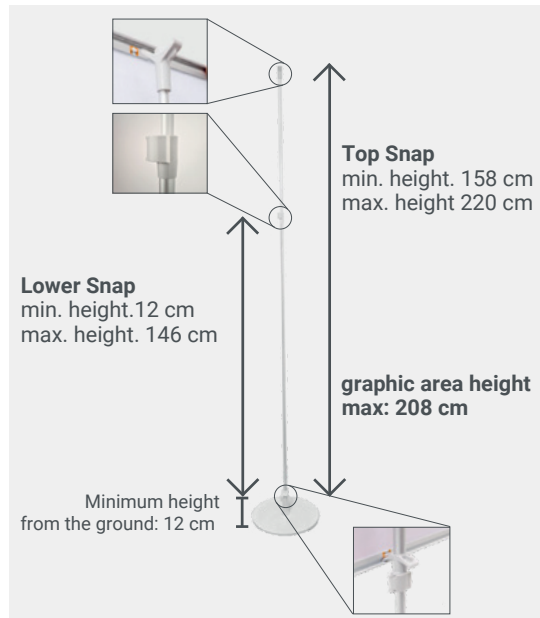

Component parts:

1. Banner stand
2. Snap Rail (x4)
3. print (x2)
4. carrying bag

graphic area heights achievable with the lower rod and/or with the extension of the rod upper, moving the clips present.

## STRUCTURE ASSEMBLY

1

Assemble the auction joining the poles.



2

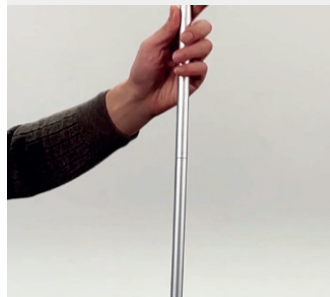

3

Fix the base roundabout at auction with Allen 4 mm



4

Adjust the height of the rod using the center clip.

PS: holds the upper rod fixed with a hand to avitate that it should come down



## GRAPHICAL ASSEMBLY

1

Remove the caps from the snap rail to open them.



2

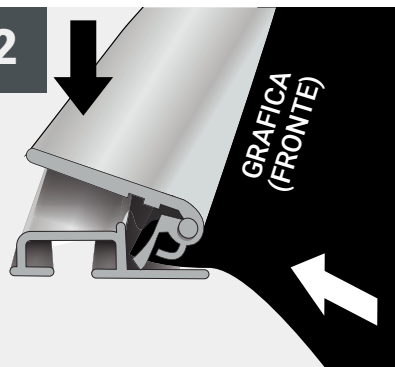

with the graphics facing up insert the edge completely upper in the groove of the snap rail and press to close.

3

Close the snap rail on the sides with caps.

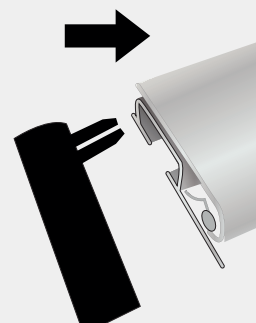

4

Align the groove of the top snap rail with clip in top of the rod and fix it



5

Unlock the bottom clip of the rod to adjust its height.



6

Lock the clip where the snap rail can be hooked and the graphics are on tension



Repeat this operation to the second graphic