

## ASSEMBLY INSTRUCTIONS

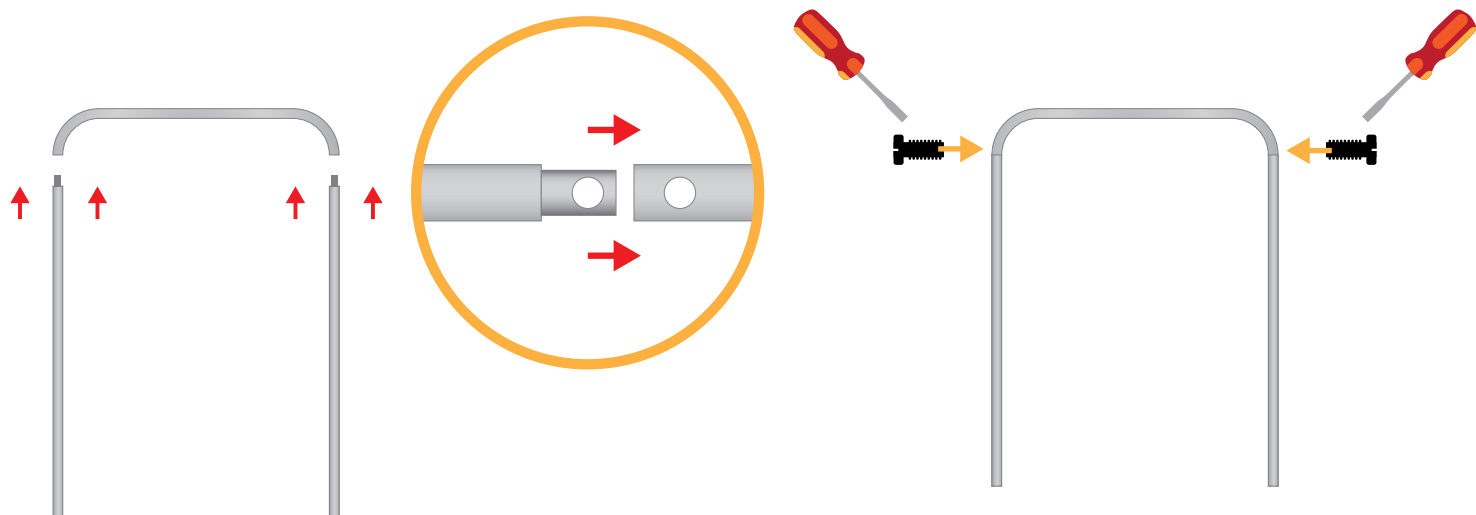

1. Join the curved rod with the 2 vertical rods and secure with the screws supplied

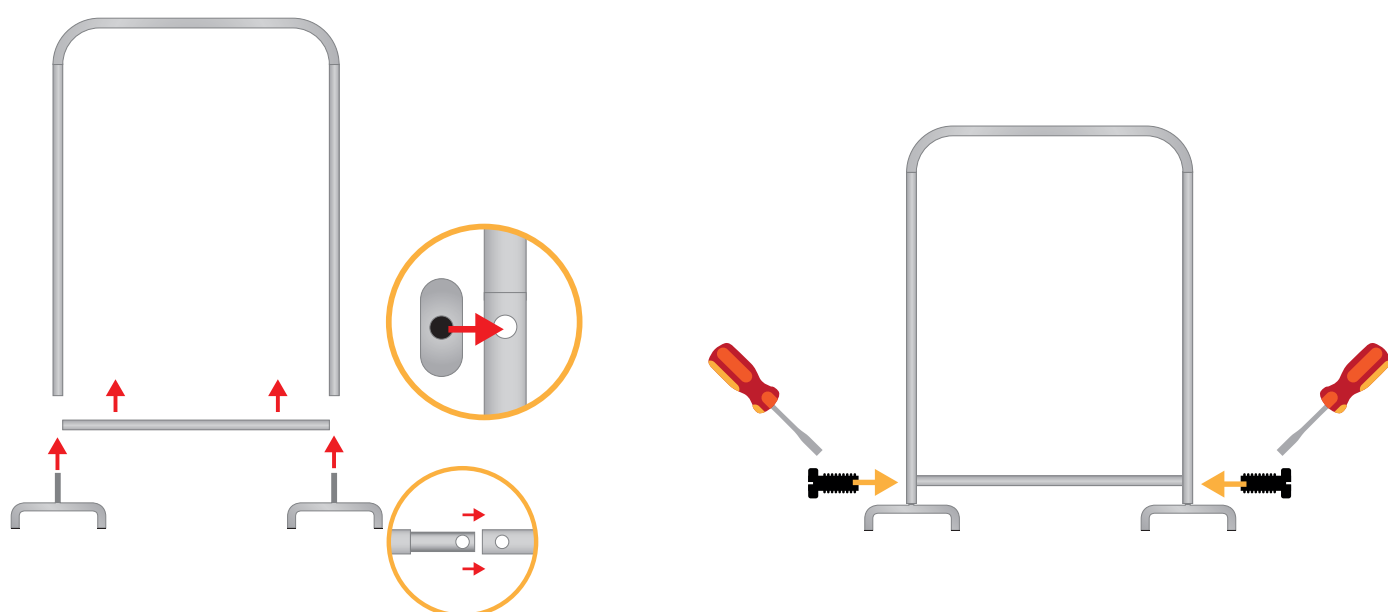

2. Insert the pin of the feet into the vertical rods, position the horizontal rod and secure with the screws supplied

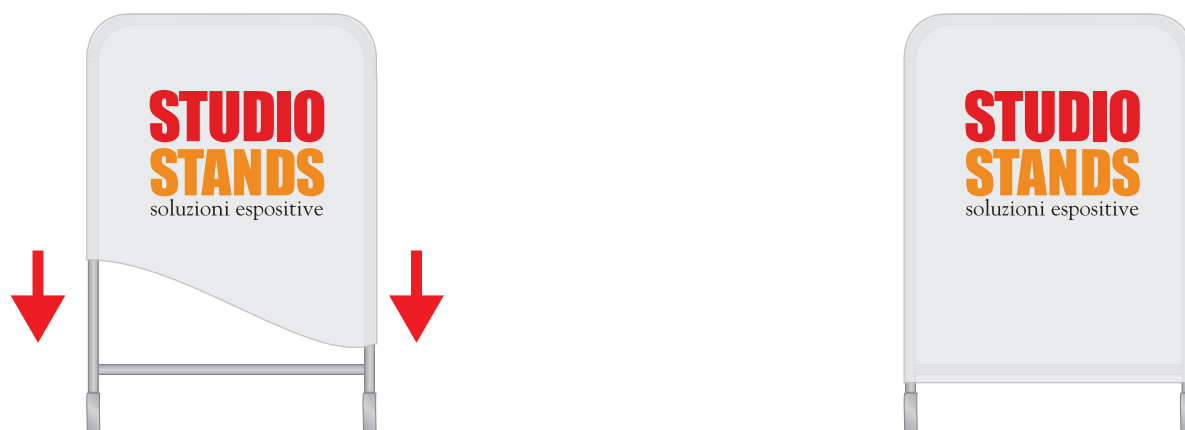

3. Apply the print to the structure by inserting it like a sock

# INFO FILE

## Formats:

.eps .pdf .jpg .tiff

## Color profile:

CMYK

## Images:

included within the file at at least 100dpi resolution in 1:1 scale or 1000dpi for 1:10 scale works

## Fonts:

converted into paths

## Die path:

Keep ONLY the outermost path - all other paths must be removed

## Crop marks/register/color bars/file info:

DO NOT insert inside the file

———— **ABUNDANCE**

———— **CUT**

———— **SAFETY MARGIN**  
(Do not place important content beyond this margin)

TRACKS IN 1:10 SCALE

