

ASSEMBLY INSTRUCTIONS

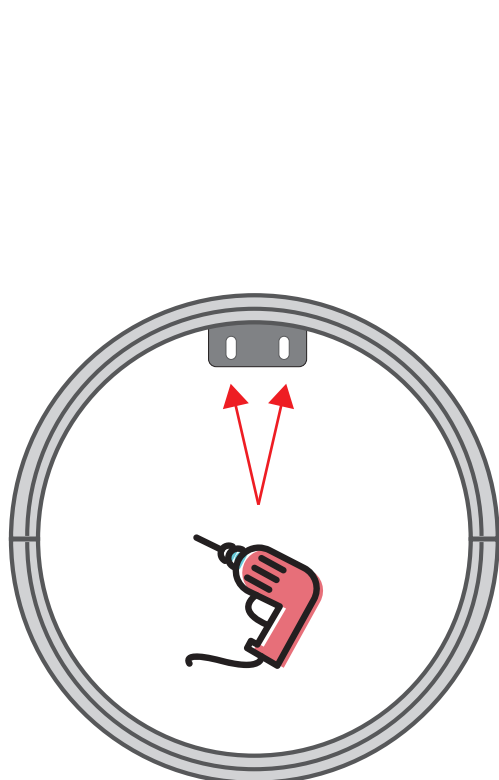
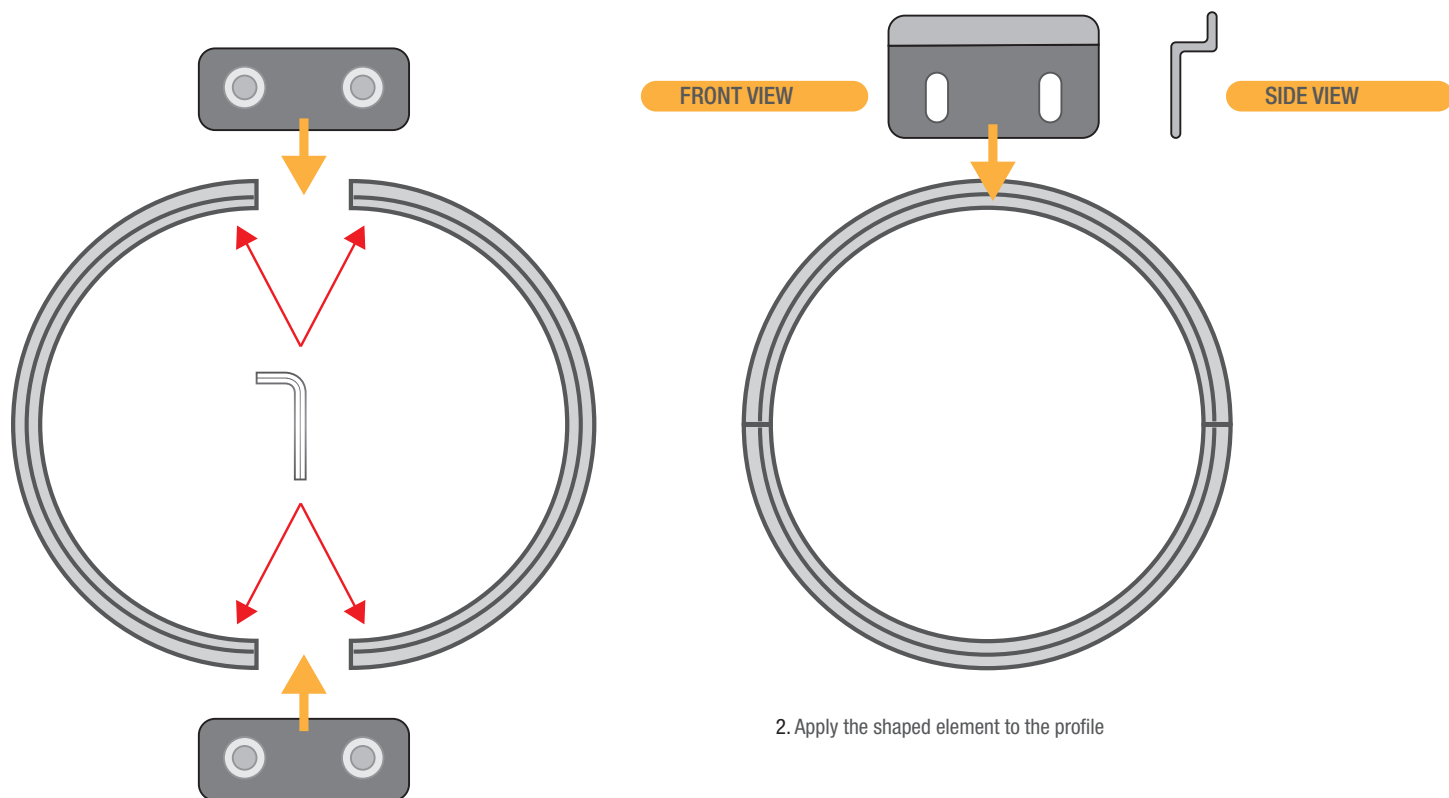

INFO FILE

Formats:

.eps .pdf .jpg .tiff

Color profile:

CMYK

Images:

included within the file at at least 100dpi resolution in 1:1 scale or 1000dpi for 1:10 scale works

Fonts:

converted into paths

Die path:

Keep ONLY the outermost path - all other paths must be removed

Crop marks/register/color bars/file info:

DO NOT insert inside the file

———— **ABUNDANCE**

———— **CUT**

———— **SAFETY MARGIN**
(Do not place important content beyond this margin)

