

**FITTING A**  
(on the upper wall)

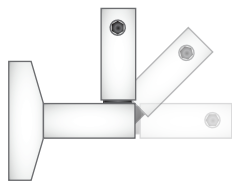

**FITTING B**  
(on the lower wall)

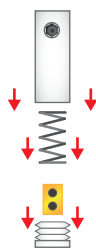

**FITTING C**  
(on the floor)

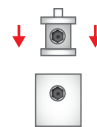

**FITTING D**  
(ceiling)



**FITTING E**  
(counterweight)

**1.** Drill the wall/ceiling/floor according to the chosen configuration; apply the fittings using screws and plugs, positioning them at the necessary distance imposed by the dimensions of the communication holder.

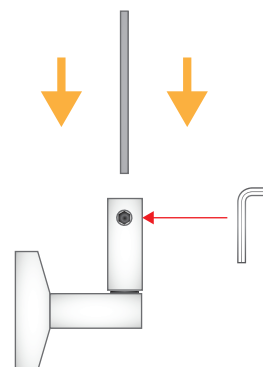
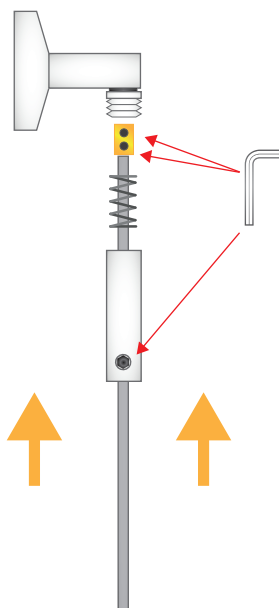

**2.** Disassemble fitting A (consisting of 1 hollow cylinder, 1 spring and 1 brass cylinder). Insert the cable into the hollow cylinder and apply the spring. Remove the studs from the brass cylinder, insert the cable and then reposition the studs

**Attenzione** - Tighten well to prevent it from coming off with the weight of the communication holder.

Restore Connection A to the initial configuration and then act on the visible bolt.

**NOTE:** This instruction sheet presents a configuration with fittings A and B; the assembly of the structure remains unchanged even using fittings C, D and E.

**3.** Insert the cable into fitting B then use the Allen key on the visible screw

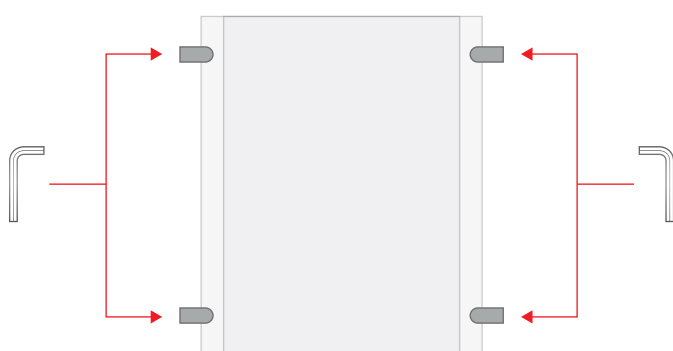

**4.** Using an Allen key, remove the small screws present in the perimeter connections of the communication holders.

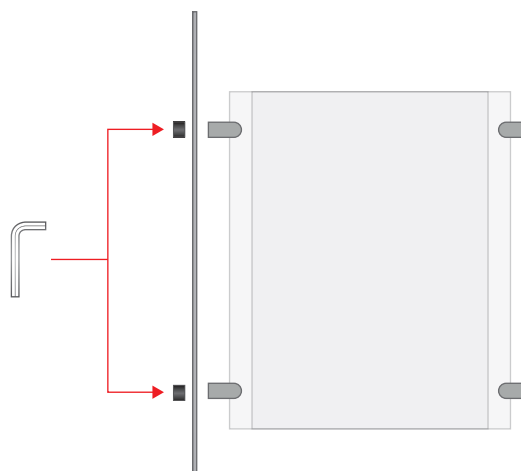

**5.** Position the communication holders at the desired height by inserting the cables into the perimeter attachments of the display, then secure by repositioning the pegs removed previously.



6. Inserire le stampe nelle tasche dei porta comunicazione



[youtube.com/StudioStandSrl](https://youtube.com/StudioStandSrl)  
for the assembly video tutorial

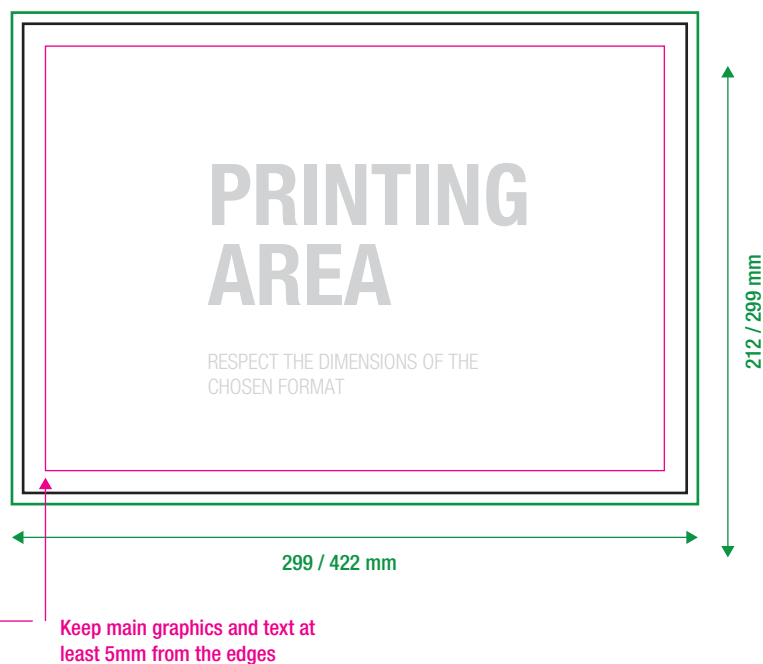
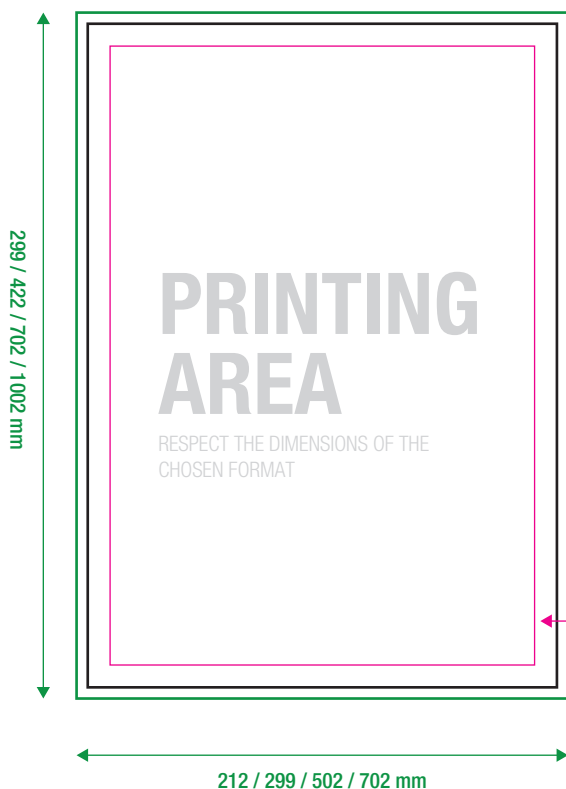

- **ABUNDANCE**
- **CUT**
- **SAFETY MARGIN**  
(Do not place important content beyond this margin))

## INFO FILE

Formats: .eps .pdf .jpg .tiff  
Color profile: CMYK  
Images: 100dpi - 1000dpi (for 1:10 scale files)  
Fonts: converted into paths  
Die path: only cutting path (where present)