

ASSEMBLY INSTRUCTIONS

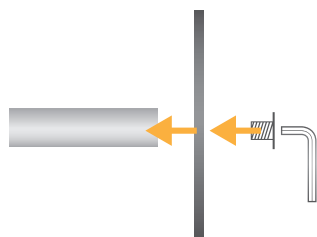

- 1.** Screw the base to the pole with the supplied Allen key
Note - tighten the screw securely

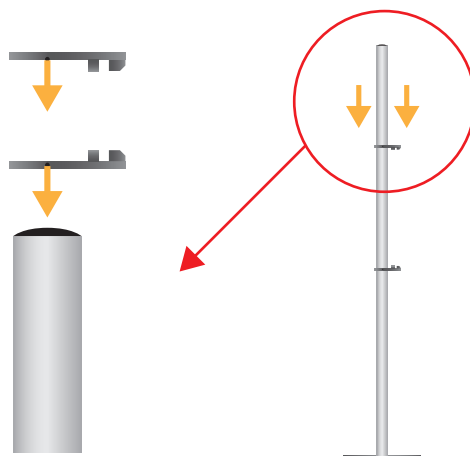

- 2.** Insert the two rings facing mirror-wise as shown in the

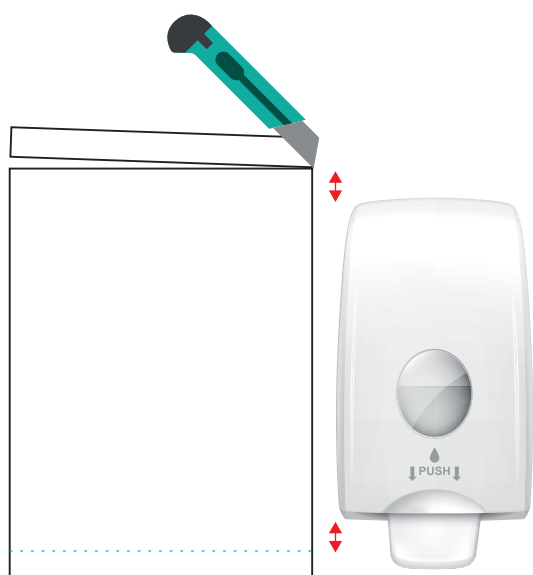

- 3.(for purchases without dispensers)** Cut the supplied panel using a cutter and ruler to match the dimensions of your dispenser
Note - approx 4cm longer

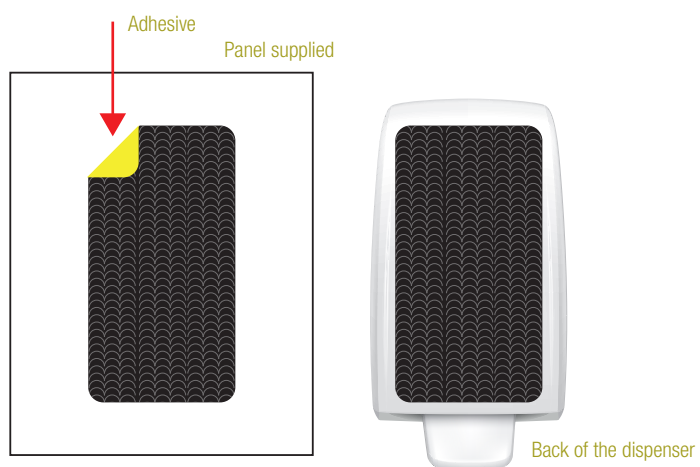

- 4.(for purchases without dispensers)** Apply the dual lock Velcro on the back of the dispenser and on the panel

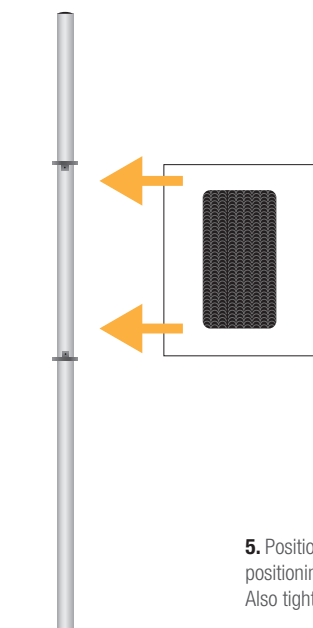

- 5.** Position the panel in the groove of the two rings previously inserted into the pole, tighten the Allen keys, positioning the rings and panel at the desired height.
Also tighten the screws on the front of the rings to secure the panel.

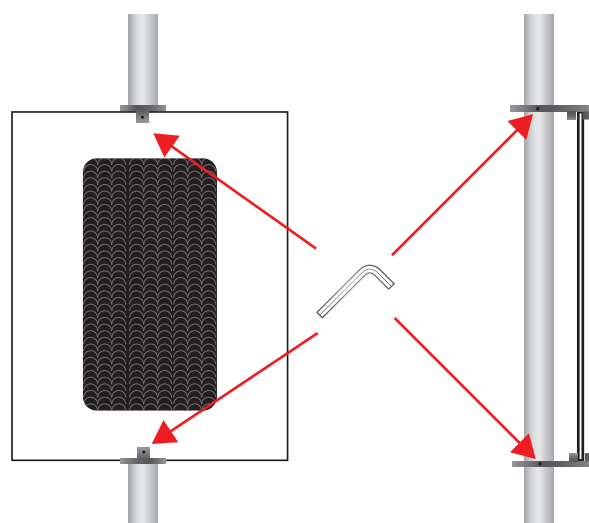

OPTIONAL for DNA dispenser



6. Adhere the dispenser using dual lock Velcro

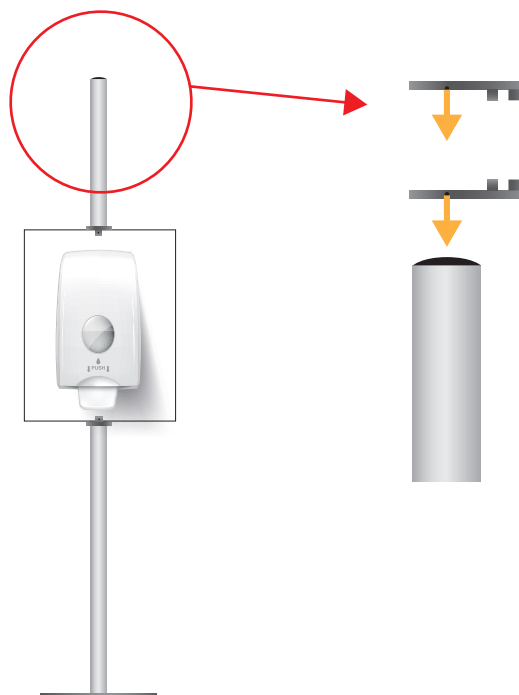

7. Insert the two rings facing oppositely as previously done

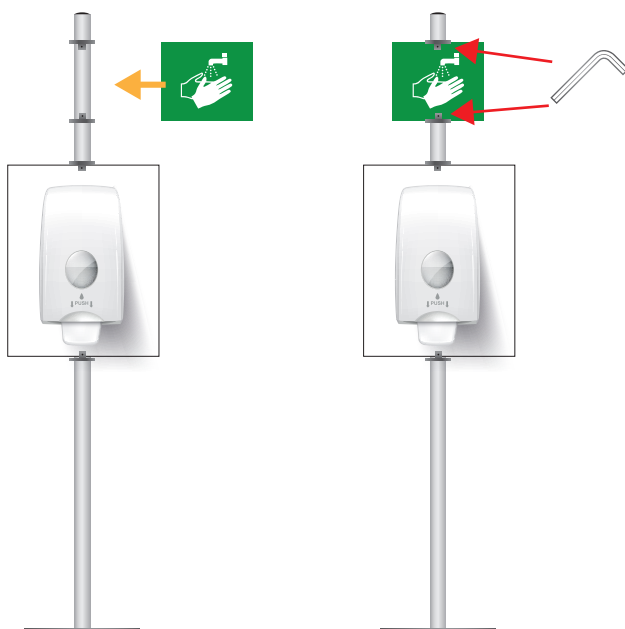

8. Position the small panel in the groove of the two rings previously inserted into the pole, tighten the Allen keys, positioning the rings at the desired height.

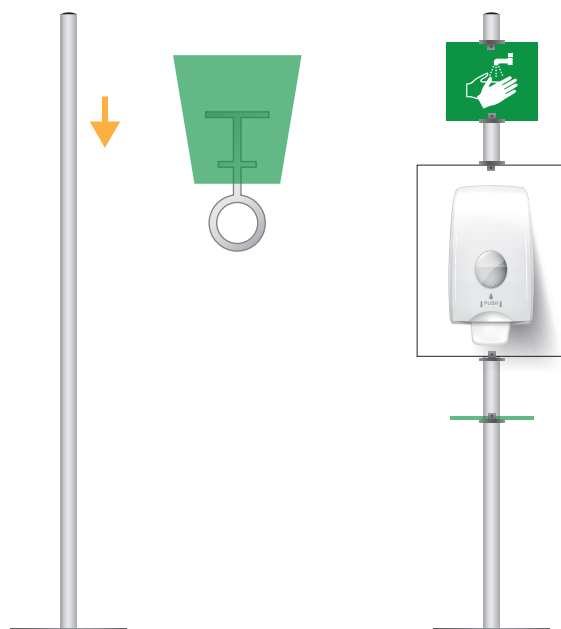

9. Screw the trapezoidal transparent plexiglass shelf to the relative metal frame using the double-headed screws provided. Insert it into the pole first, so that it is underneath the two rings with the dispenser support panel.